



### *The Patriot Motor / \*\*The Patriot motor with light*

#### **\*\*PLEASE KEEP THE SHIPPING BOX FOR AT LEAST 2 WEEKS\*\***

**Important Note:** Power supply should be turned off prior to any contact with the electrical wires. It is recommended that a licensed electrician be hired to install your fan. Make sure the fan mounting bracket is attached securely to the ceiling, preferably a ceiling stud - strong enough to hold this larger than normal fan. Observe all local and national electrical codes. This is a two-person job. You may consider removing 3 blades to make room for you to be closer to the motor during installation. \*Notice that the fan may need to be calibrated, if so allow approximately 2-3 min. Follow step 10. *(Follow \*\*additional steps for fan with light model)*

#### **Installation Instructions:**

- 1) Mount the hanger bracket to the ceiling with two suitable screws or bolts. **Be sure you mount this securely to the ceiling!**
- 2) **\*\*Connect four prong plug to light bulb, then attach round light to top of motor using the three clips before hanging the fan.**
- 3) Remove ball mount from down rod, removing the small screw on the side of ball. Run the wires and safety cable through the down rod and attach the down rod to motor securing with clevis pin and hairpin clip.
- 4) Route wires and safety cable through motor coupling cover, canopy screw cover and ceiling canopy. Placing them as follows through the down rod and rest it on top of the motor.
- 5) Route wires and safety cable through ball mount and align the ball so the pin is captured in the ball up tight against the pin. Securely tighten the set screw in the ball mount.
- 6) Lift the fan and place the hanger ball into the ceiling mount making sure the ball mount locks in with the groove.
- 7) **\*make sure both receiver and wall control have same frequency setting. Located inside wall control and on back of receiver.** \*Place receiver in hanger bracket. Connect the electric motor wires ((\*\*blue,\*\*brown is for light), red, gray, yellow.) to the dc receiver. Connect all your ground wires to the ceiling ground.
- 8) Connect the household supply wires (120 Volt AC, 60 Hz, 15-amp circuit) to Sensor. Black house wire to black sensor wire, White house wire to white motor and white sensor wire.
- 9) Push the wires and sensor into the ceiling mount area to prepare for the ceiling cover canopy.
- 10) Lift the ceiling cover up to the ceiling mount and spin it until it aligns with the mount screws., then attach with the two small screws provided. And cover screws with the canopy screw cover.
- 11) Attach all the blades using the self-tapping screws provided, while wearing safety goggles due to metal shavings falling.
- 12) The sensor and Wall control are already synced before shipping. Connect **AC IN L** to Ac power source. Connect Black **Motor L** to black AC IN L wire going to receiver on fan. Connect your neutral house wire with the neutral white wire going to receiver. Make sure switch is on off. Before turning power back on. *\*Fans powered with remote control have to be wired to on/off house switch.* Wall control has a Power On switch. Power on fan and start your fan on low speed while adding speed. Forward and reverse buttons are at the bottom corners with a winter and summer symbol.
- 13) If there is no movement in fan then the motor needs to calibrate with the blade system weight. Start with powering off fan. Find the small black learn button on control either on back of remote inside, or on the front of wall control once you take the cover off.. Within 30 seconds of powering on fan (switch is on) press the learn button. This may take a couple of minutes when first installing. Allow for two minutes for the fan and control to sync. Do not press any other buttons until fan comes to full stop.
- 14) Clear the area and provide power to the fan to check for wobble. Use the provided balancing kit to minimize wobble (if needed), following the balancing kit instructions. Normal high speed is 29 to 40 RPM. \*Fan works best when starting on low speed and gradually increasing.

***Call our helpline for assistance at 972-834-5555.***

# PATRIOT MOTOR WIRING INSTRUCCIONS

\* if fan does not include wall control, fan should be wired to regular on/off switch.

## FREQUENCY SETTING

\*dip switches on remote and/or wall control must match with receiver

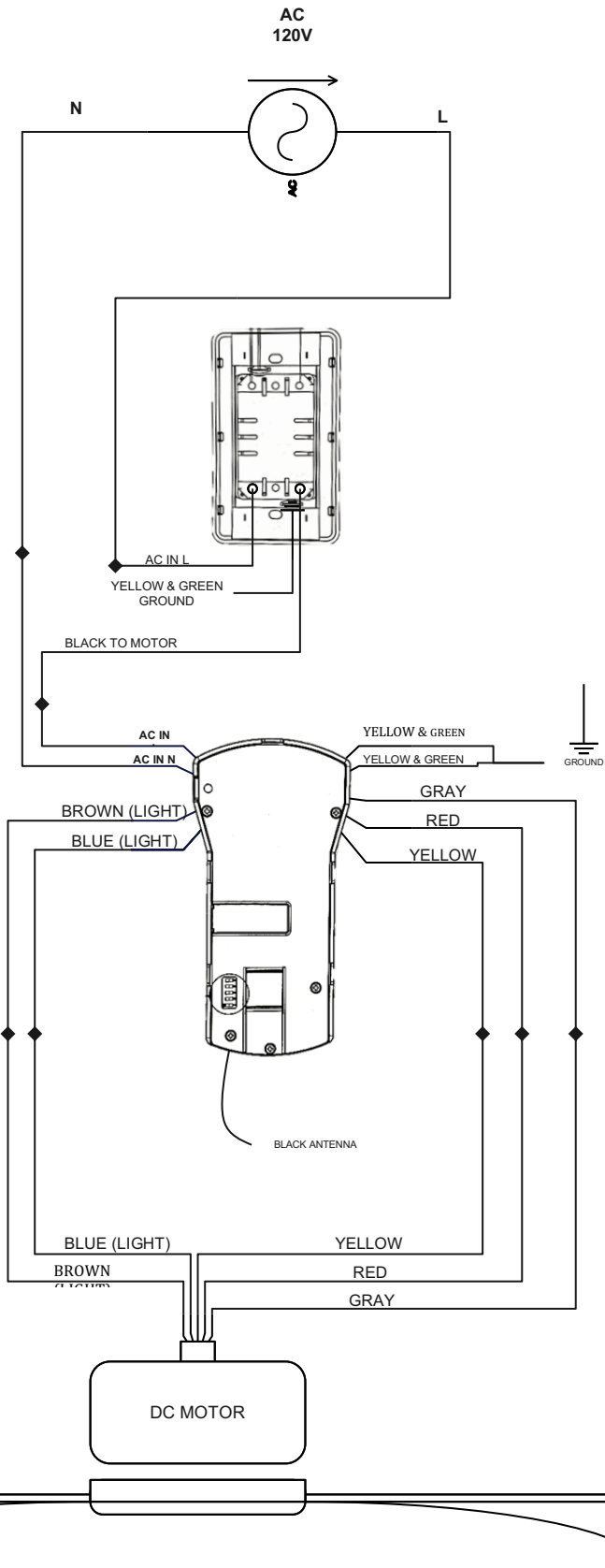
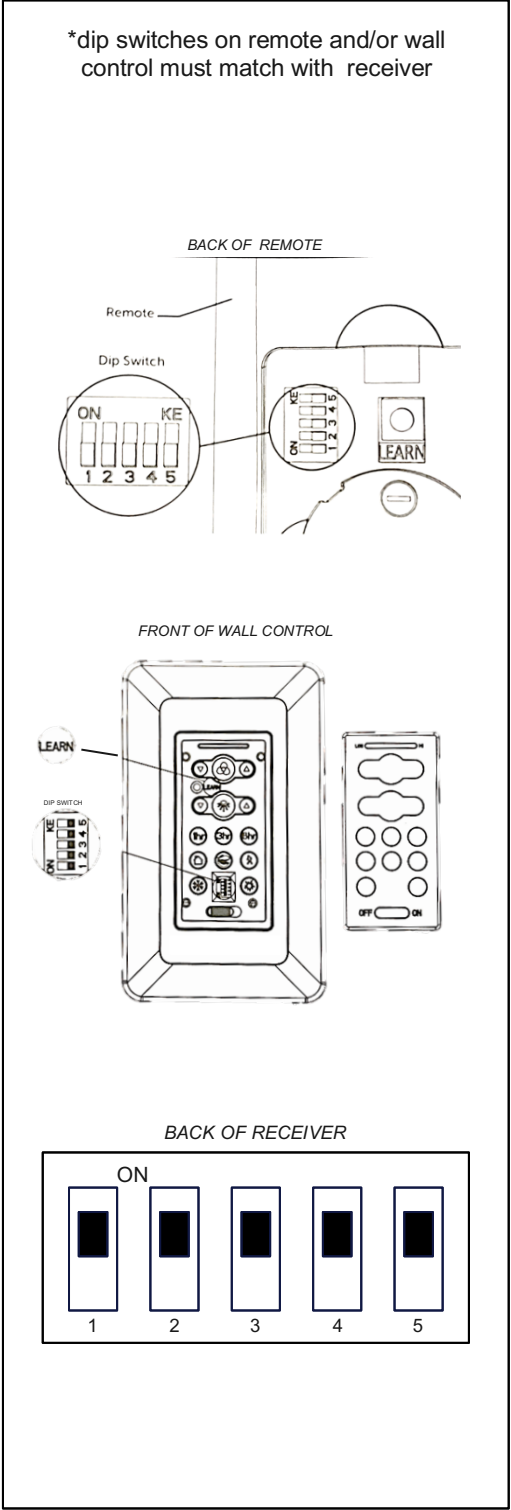

## Reference Sheet:

### Step 1:



Bracket



suitable screws

### Step 2:



Light bulb attached to to the motor

### Step 3:



Ball mount and down rod



clevis pin and hairpin clip

### Step 4:

ceiling canopy



canopy screw cover



coupling cover



motor wires

### Step 5:



Ball mount and down rod



### Step

### 7:



Receiver  
Receiver threaded through



ball mount

### Step 12:



Wall Control



Remote Control

### Step 13:



Learn button on  
the wall control



Learn button on the  
the remote control

Home Away: Light will turn off and on randomly while you are away.

Fresh Air: fan speed will modulate to simulate natural breeze.

Summer: fan runs counterclockwise

ON / Off



Fan Speed

Light switch

Sleep Timer. Fan turns off after 1hr, 3hr, 6hr

Safe Exit: Fan and light will turn off after 1 minute.

Winter: fan runs clockwise